

So Carolina

(67)

Pursuant to warrant from Comd Thomas Esq. Co. L. in the district of Greenville dated the 26<sup>th</sup> Aug. 1811. I have admeasured & laid out unto Jordan Holcombs a tract of land containing Twenty five acres and fifty Chains - situated in the said District on a branch the waters of Middle Tygar River - bounded by a line running W. 1/2 N. E. by lands laid out unto said Holcombs & by lands granted to John Gowen & Co. by land laid out unto Thos. Barton & hath such form & marks as the above plat represents. Surveyed the 28<sup>th</sup> August 1811 - Recorded the 31<sup>st</sup> day of Aug. 1811 DeWolf & Co. W. Whitten D.

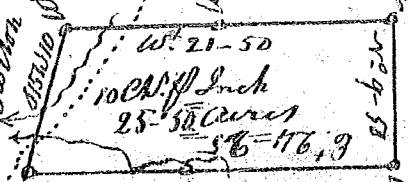

John Gowen

Scale, 10 Ch. 1/2 Inch. John Furton, Surveyor, Ch. Beavers. Wm. Nicholson, Field. Post O. 37 DeW. The above plat represents - Surveyed this 22<sup>nd</sup> October 1811 - Recorded this 24<sup>th</sup> October 1811 - Del. W. Bevant.

State of So Carolina

Pursuant to a warrant from Comd Thomas Esq. Locations for Greenville district, bearing date 15<sup>th</sup> day of October 1811 - I have admeasured & laid out unto



Ele Baldwin, a tract of nine acres of land, situate in Greenville District of State aforesaid, on both sides of the head branch of Rocky creek of Reedy river - bounded by a line running N. W. by William Nicholson's land S. E. by said Ele Baldwin's S. E. & N. E. by Wm. Beed's lands & hath such shape form & marks as the above plat represents - Surveyed this 22<sup>nd</sup> October 1811 - Recorded this 24<sup>th</sup> October 1811 - Del. W. Bevant.

James Pilgore, D. S.

Recorded this 24<sup>th</sup> October 1811 - Del. W. Bevant.